

FOR LEASE



3151 NE Sandy Blvd. Portland, OR 97232

3 Private Offices | 138 - 218 SF Suites
\$550 - \$780/mo. flat rate

Debbie Thomas | Listing Broker
503.720.6335 | deb@debbiethomas.com



YOUR URBAN REAL ESTATE RESOURCE

THE BUILDING

This charming **office building** features tons of natural light, on-site parking and easy I-84 access. It is close to the bustling **Hollywood and Broadway** business districts, the **Bindery Building, Restaurant Row**, and less than 10 minutes to downtown.



3 Private Offices

3 Restrooms

Conference Room

Reception Area

Shared Waiting Room

Kitchen & Breakroom

Storage Areas

On-Site Parking



THE SPACE

1ST FLOOR:

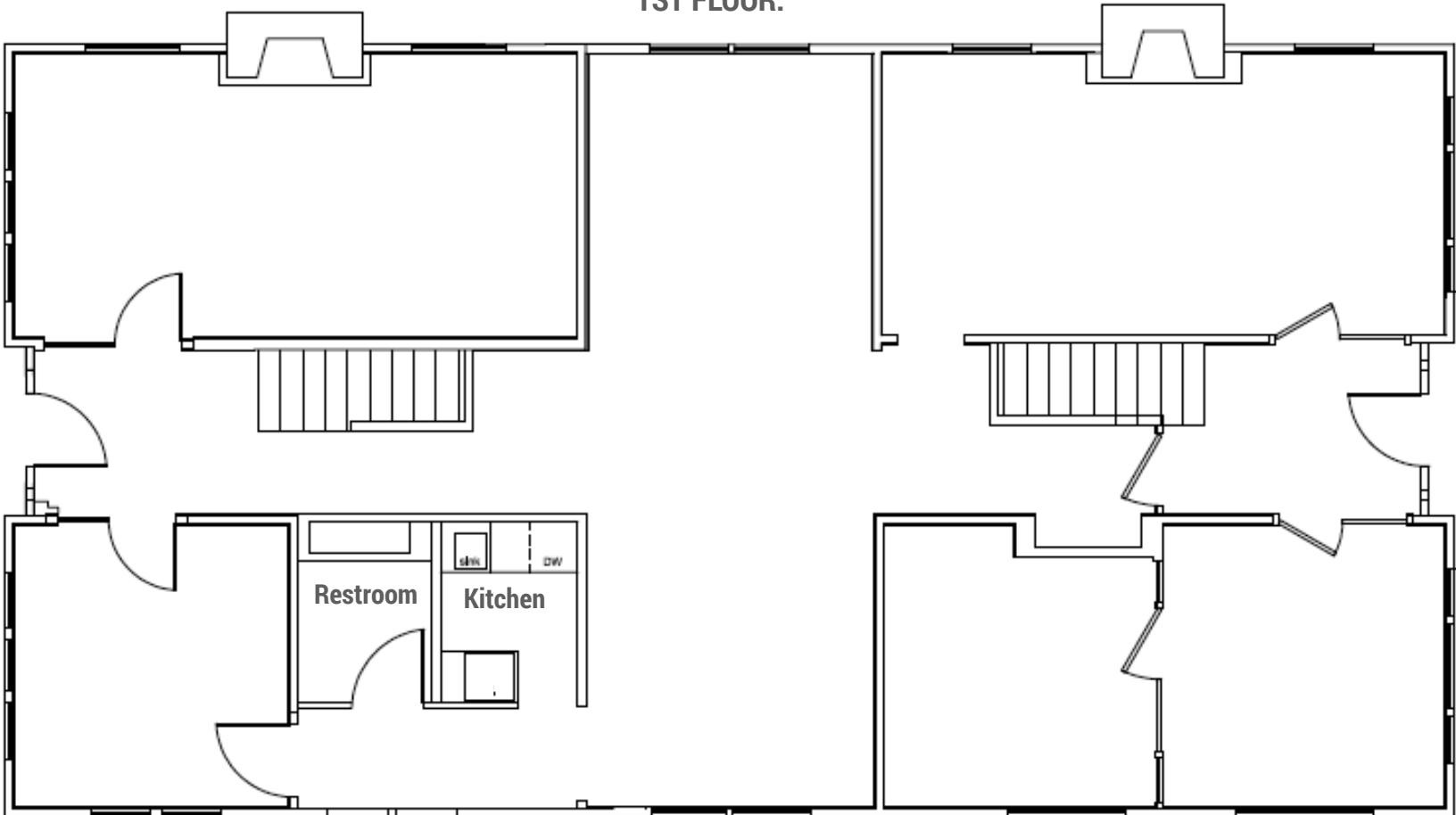

2ND FLOOR:

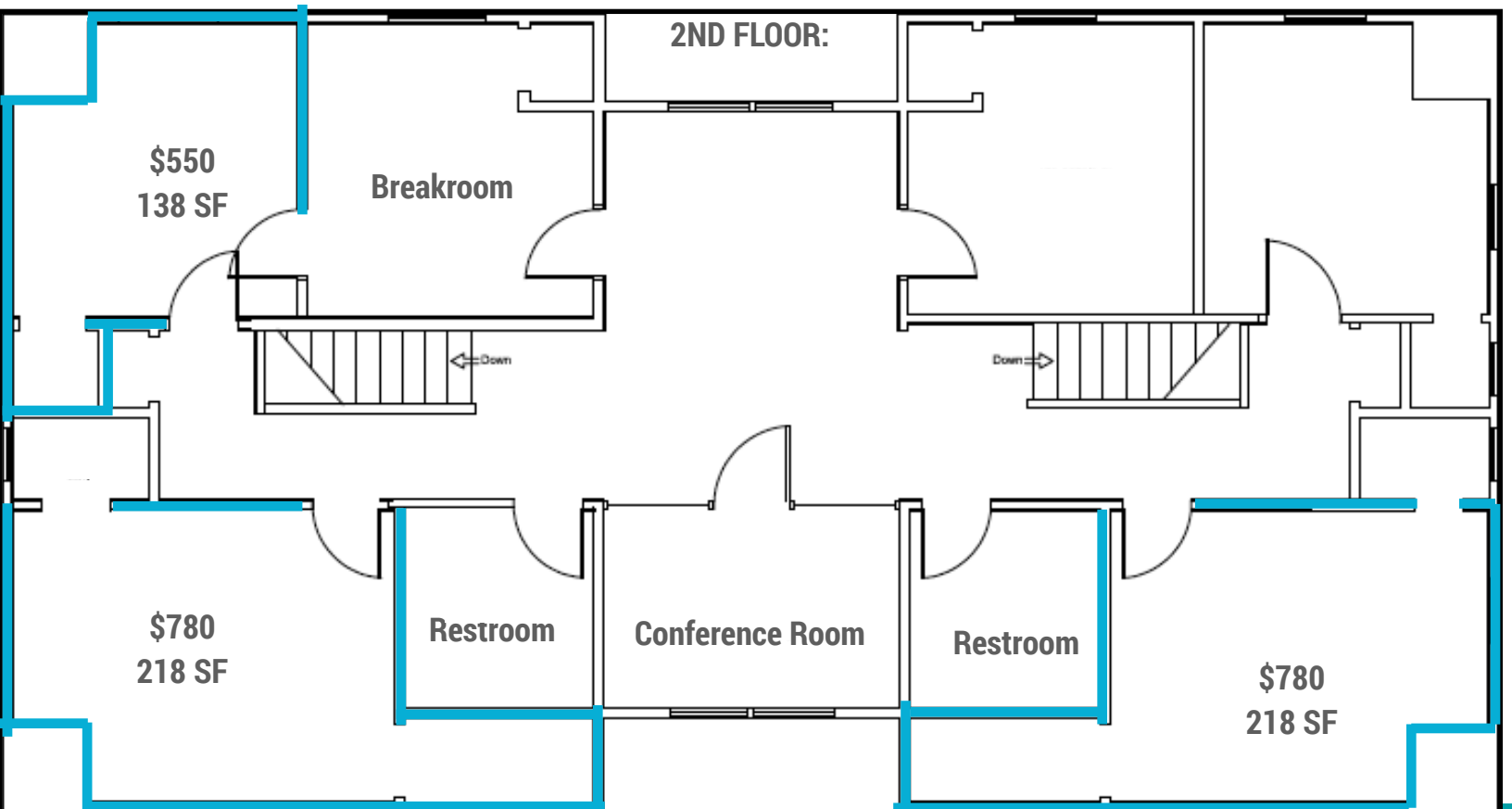

THE NEIGHBORHOOD

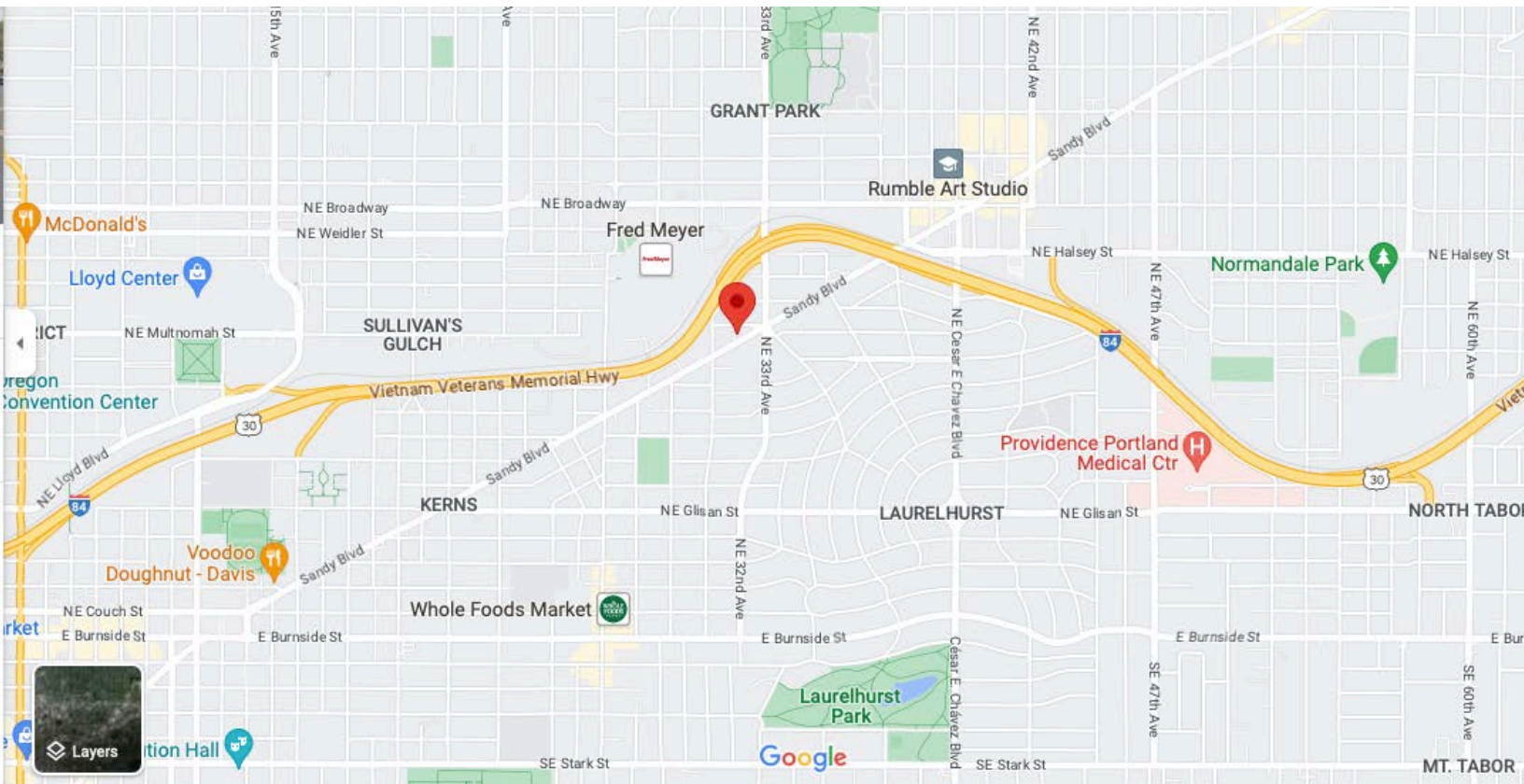

VERY WALKABLE

80



SOME TRANSIT

46



BIKER'S PARADISE

96



SHOP

Lloyd Center Mall
 Whole Foods Market
 Fred Meyer
 Target
 Trader Joes
 Creative Culture
 Mountain Shop
 Bricks & Minifigs
 Music Millenium
 Hollywood Vintage

EAT

Voodoo Donuts
 Petite Provence
 Alex Mexican Cantina
 Guero
 Boxcar Pizza
 Pambiche
 The Moon & Sixpence
 Stammish
 Fire on the Mountain
 Screen Door

PLAY

Laurelhurst Park
 Grant Park
 Doug Fir Lounge
 Moda Center
 Revolution Hall
 Hollywood Theatre
 Rumble Art Studio
 Colonel Summers Park
 The Circuit Bouldering Gym
 Buckman Field Park

The information contained herein has been obtained from sources we deem reliable. We do not guarantee its accuracy. All information should be verified prior to purchase or lease.