

# FOR LEASE



## The Jowers Building

8801 N Lombard St.

2031 SF

\$24/SF + NNN

Under \$4800/mo., including low nets

\*Not an as-built. Space includes: 2 restrooms, large walk-in refrigerator, kitchen & bar



Debbie Thomas | Principal Broker | 503.226.2141 | c:503.720.6335 | [deb@debbiethomas.com](mailto:deb@debbiethomas.com) | [debbiethomas.com](http://debbiethomas.com)

YOUR URBAN REAL ESTATE RESOURCE

# THE BUILDING



# FLOOR PLAN

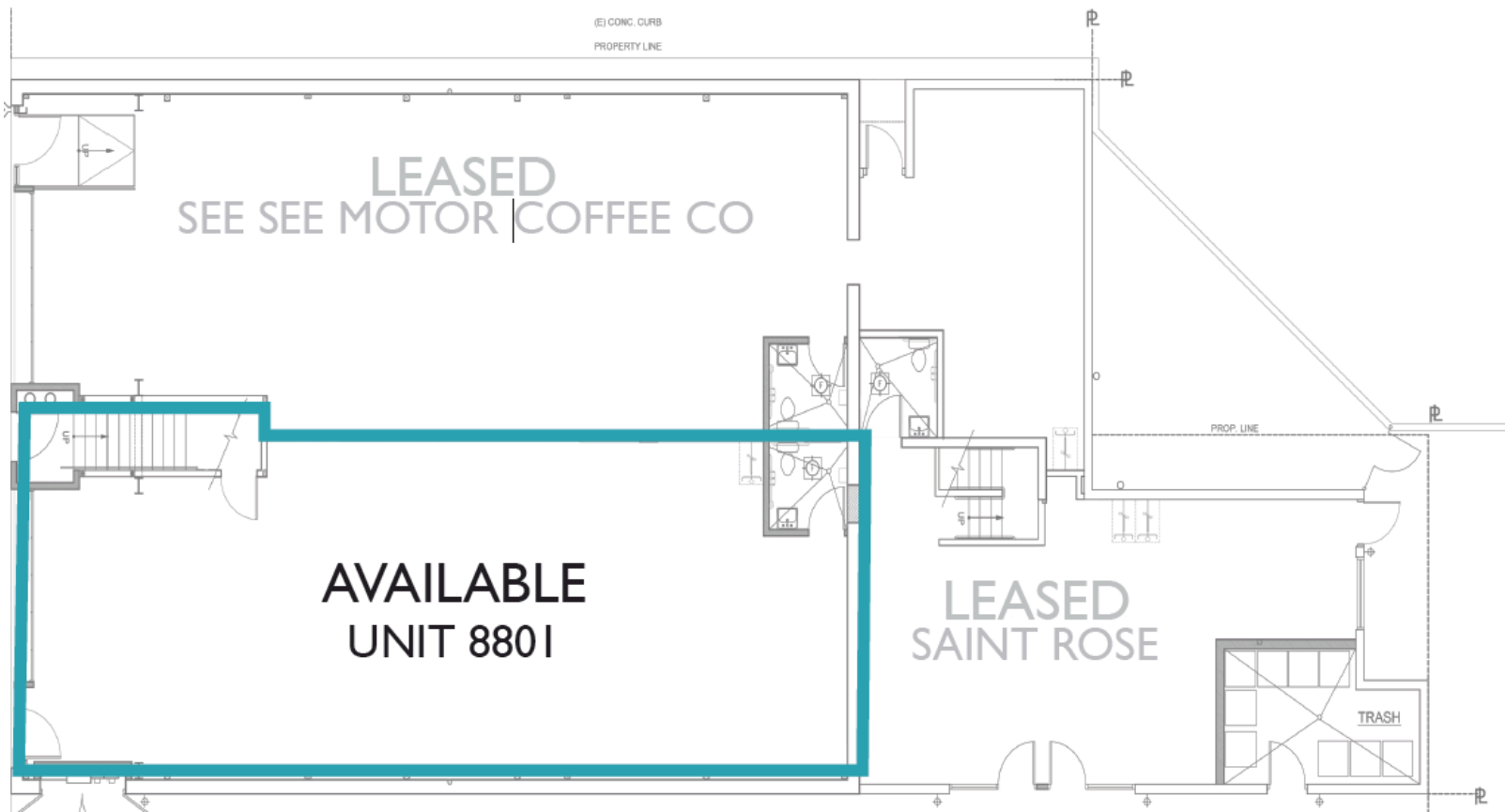

## DESIRED USES

2nd Generation  
Restaurant Space  
with Type II Hood

Located in the heart of the historic St. Johns neighborhood in North Portland – within a few blocks of abundant new housing. Highly walkable and biker friendly area just minutes away from the lovely Cathedral Park!



**Walker's Paradise**  
Daily errands do not require a car.



**Some Transit**  
A few nearby public transportation options.



**Biker's Paradise**  
Daily errands can be accomplished on a bike.





**Debbie Thomas**

COMMERCIAL BROKER

C: 503.720.6335

deb@debbiethomas.com



402 NW 13th avenue, Portland, OR 97209 | 503.226.2141 | [debbiethomas.com](http://debbiethomas.com)

YOUR URBAN REAL ESTATE RESOURCE